

RECOMMENDED P.C.B. LAND

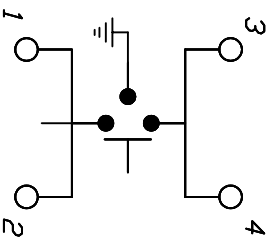

CIRCUIT: SPST

Coplanar w/in 0.10 (.004") Total, 5 Terminals

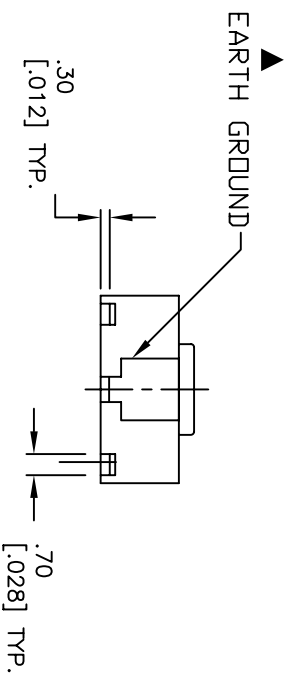
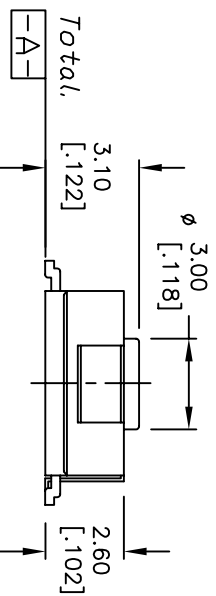

NOTES:

1. ALL DIMENSIONS IN MM [INCH]  
~UNLESS OTHERWISE SPECIFIED
2. GENERAL TOLERANCE: X.X=±0.4  
X.XX=±0.25
3. TERMINAL NOS FOR REF. ONLY
4. TRAVEL: 0.25 +0.2/-0.1mm
5. RATING: 50mA, 12VDC
6. OPERATING FORCE: 160±50gf
7. CONTACT RESISTANCE: 100M OHM MAX.
8. PACKAGED: 1,500 PCS./REEL
9. CONTACT DOME STAINLESS STEEL
10. ▲ DENOTES CRITICAL PARAMETER.
11. ELECTRICAL LIFE: 1,000,000
- 12.2002/95/EC (ROHS)COMPLIANT

B	15288	ADD NOTES 11,12 MOVE GROUND PT.	9/16/05	PH
A	13953	RELEASED FOR PRODUCTION	4/22/04	AR
REV.	ECN No.	DESCRIPTION	DATE	CHKD

TITLE		TLE3303F1600GSSDOME		
SCALE	DATE	DR	DWG	REV
4:1	4/22/04	AR	P010546	B

**E-SWITCH®**

THE INFORMATION CONTAINED IN THIS DOCUMENT IS PROPRIETARY TO E-SWITCH AND IS NOT TO BE COPIED OR TRANSFERRED